

**STRIPPER JIG**

# WHAT'S WHAT...

A JIG IS A TOOL WHICH IS USED TO CONTROL THE MOTION OF ANOTHER TOOL.

A STRIPPER JIG HOLDS A PLAYING CARD, AND GUIDES A RAZOR BLADE ALONG IT'S EDGE, SHAVING A WHISKER OFF THE CARD.

ADJUSTABLE SETTINGS CONTROL THE PLAYING CARD'S LOCATION, ENABLING A VARIABLE DEPTH OF CUT.

ANGLED OR STRAIGHT CUTS CAN PRODUCE A VARIETY OF GAFFED CARDS OR DECKS.

THE JIG HOLDS POKER OR BRIDGE SIZE CARDS IN EITHER PORTRAIT OR LANDSCAPE POSITION.

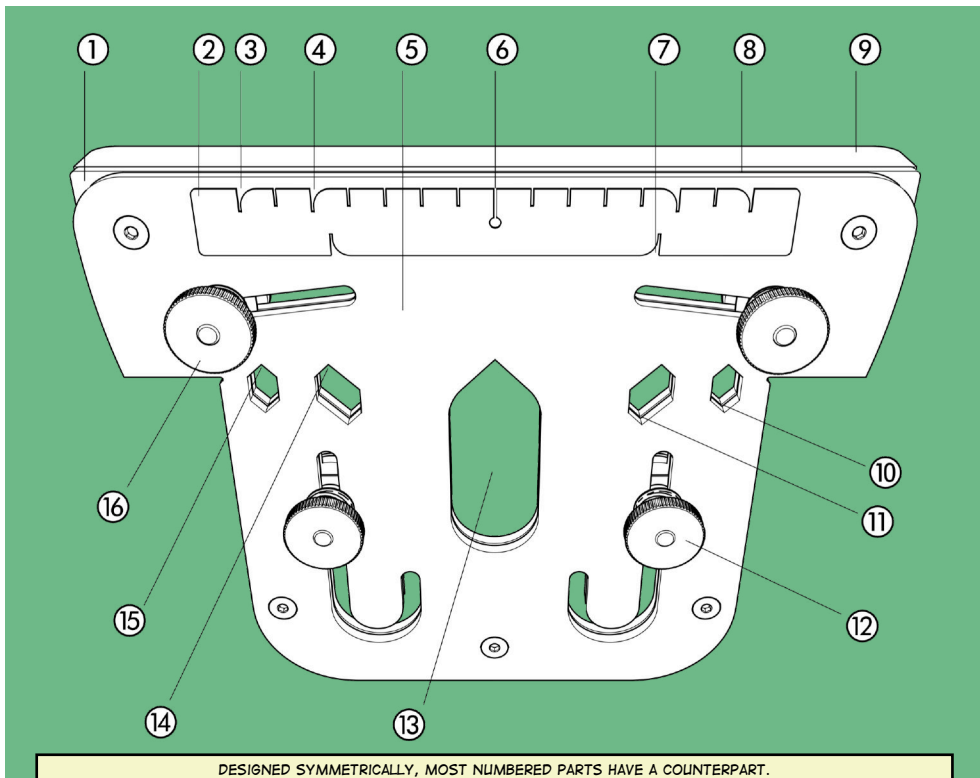

DESIGNED SYMMETRICALLY, MOST NUMBERED PARTS HAVE A COUNTERPART.

THE JIG CAN BE USED IN EITHER HAND, ALTHOUGH, THESE INSTRUCTIONS DESCRIBE THE ACTIONS OF A RIGHT-HANDED USER.

① - **CORNER LIP.**

PLACING THE EDGE OF A PLAYING CARD HERE, ENABLES YOU TO MANOEUVRE IT EASILY INTO THE JIG.

② - **GAUGE.**

THIS NOTCHED GAUGE HELPS DETERMINE THE LENGTH OF THE TAPER CUT, AS WELL AS ENABLING YOU TO REPEAT FAVOURITE SETTINGS. IT ALSO PROVIDES VISUAL REFERENCE FOR THE POSITION OF THE CARD WITHIN THE JIG.

③ - **POKER/BRIDGE LENGTH MARKER.**

WHEN A POKER OR BRIDGE SIZE PLAYING CARD HAS BEEN CENTRED WITHIN THE JIG IN A LANDSCAPE ORIENTATION, THIS MARKER INDICATES THE POSITION OF THE CARD'S CORNER.

④ - **POKER WIDTH MARKER.**

WHEN A POKER SIZE PLAYING CARD HAS BEEN CENTRED WITHIN THE JIG IN A PORTRAIT ORIENTATION, THIS MARKER INDICATES THE POSITION OF THE CARD'S CORNER.

⑤ - **FACE PLATE.**

THE MAIN SIDE OF THE JIG, THE REVERSE SIDE IS THE BACK PLATE.

⑥ - **MID-POINT MARKER.**

WHEN A PLAYING CARD HAS BEEN CENTRED WITHIN THE JIG IN A LANDSCAPE OR PORTRAIT ORIENTATION, THIS MARKER INDICATES THE MIDPOINT POSITION ALONG THE CARD'S EDGE

⑦ - **BRIDGE WIDTH MARKER.**

WHEN A BRIDGE SIZED PLAYING CARD HAS BEEN CENTRED WITHIN THE JIG IN A PORTRAIT ORIENTATION, THIS MARKER INDICATES THE POSITION OF THE CARD'S EDGE.

⑧ - **CUT LINE GAP.**

A GAP BETWEEN THE PLATES, HOUSES ONE PLAYING CARD AT A TIME.

⑨ - **REST.**

THE REST HELPS SUPPORT THE RAZOR BLADE (AND ACTS AS A FINGER GUARD), AS IT CUTS THE CARD. IT IS ALSO USED TO STAND THE JIG UPSIDE DOWN ON A FLAT SURFACE IN ORDER TO SET THE DEPTH AND LENGTH OF THE CUT.

⑩ - **BRIDGE LENGTH SET-UP POINT.**

ALIGNING THE SHORT EDGE OF A BRIDGE SIZED PLAYING CARD TO THIS POINT IN A LANDSCAPE ORIENTATION, CENTRES THE CARD WITHIN THE JIG

⑪ - **BRIDGE WIDTH SET-UP POINT.**

ALIGNING THE LONG EDGE OF A BRIDGE SIZED PLAYING CARD TO THIS POINT IN A PORTRAIT ORIENTATION, CENTRES THE CARD WITHIN THE JIG.

⑫ - **DEPTH STOP.**

AN ADJUSTABLE THUMB SCREW STOP THAT CAN BE LOCKED INTO POSITION ALONG THE U-SHAPED SLOT IN THE JIG PLATES. THIS STOP IS USED TO DETERMINE THE DEPTH OF CUT.

⑬ - **GRIP SPACE.**

WHEN IN USE, THIS AREA EXPOSES A SECTION OF PLAYING CARD, THE CARD IS GRIPPED THROUGH THIS SPACE BY THE THUMB AND SECOND FINGER, HOLDING IT IN PLACE AGAINST THE LOCKED DOWN DEPTH STOPS, WHILST THE CARD IS CUT.

⑭ - **POKER WIDTH SET-UP POINT.**

ALIGNING THE LONG EDGE OF A POKER SIZED PLAYING CARD TO THIS POINT IN A PORTRAIT ORIENTATION, CENTRES THE CARD WITHIN THE JIG.

⑮ - **POKER LENGTH SET-UP POINT.**

ALIGNING THE SHORT EDGE OF A POKER SIZED PLAYING CARD TO THIS POINT IN A LANDSCAPE ORIENTATION, CENTRES THE CARD WITHIN THE JIG.

⑯ - **SIDE STOP.**

AN ADJUSTABLE THUMB SCREW STOP THAT CAN BE LOCKED INTO POSITION ALONG THE STRAIGHT SLOT IN THE JIG PLATES. THIS STOP IS USED TO SECURE THE CARD IN A CENTRAL POSITION WITHIN THE JIG.

THE FOLLOWING EXAMPLE USES A POKER SIZE PLAYING CARD IN LANDSCAPE POSITION TO PRODUCE A TAPERED CUT ALONG ONE LONG EDGE OF THE CARD.

THIS BASIC PROCEDURE, WITH DIFFERENT SETTINGS, CAN BE USED FOR BOTH POKER AND BRIDGE SIZE CARDS, IN LANDSCAPE OR PORTRAIT POSITION, TO PRODUCE TAPERED OR STRAIGHT CUTS.

## THE SETUP...

WRITTEN AND ILLUSTRATED BY EGIN CHASE

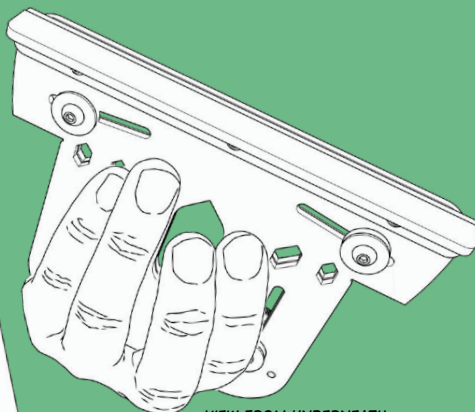
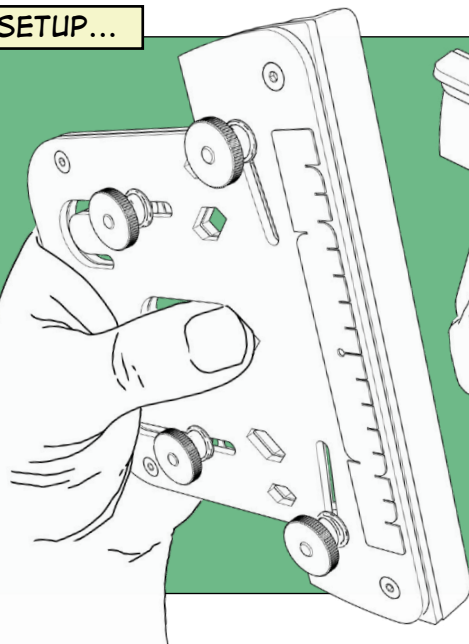

VIEW FROM UNDERNEATH

THE JIG IS HELD, *FACE PLATE UP*, IN THE PALM UP LEFT HAND, WITH THE TIPS OF BOTH THUMB AND SECOND FINGER MEETING THROUGH THE *GRIP SPACE*, ALL OTHER FINGERS SUPPORTING UNDERNEATH.

THIS POSITION WILL BE REFERRED TO AS *"HOLDING GRIP"*

WITH THE RIGHT-HAND BEGIN BY LOOSENING ALL FOUR STOPS USING THEIR THUMBSCREWS. THEY SHOULD BE ABLE TO MOVE EASILY ALONG THEIR RESPECTIVE SLOTS YET REMAIN WHEREVER PLACED DUE TO THEIR SPRINGS. MOVE THE *SIDE STOPS* TO THE OUTER EDGES AND THE *DEPTH STOPS* TOWARDS THE BOTTOM OF THE U-SLOT.

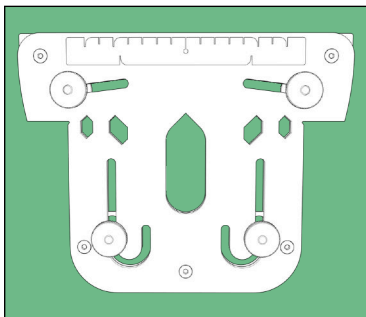

THE RIGHT HAND INSERTS A PLAYING CARD INTO THE CUT LINE GAP, USING A CORNER LIP TO INITIALLY GUIDE THE CARD.

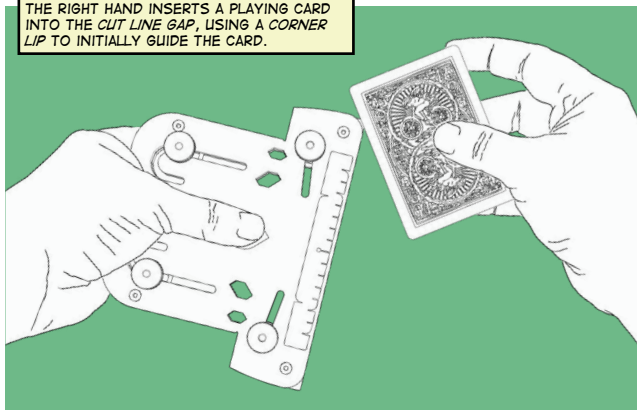

MANOEUVRE THE CARD SO THAT IT'S LONG EDGE RUNS PARALLEL WITH THE CUT LINE GAP AND PUSH IT FLUSH. THE LEFT-HAND THUMB AND SECOND FINGER NOW BRIEFLY GRIP THE CARD THROUGH THE JIGS GRIP SPACE, TO STOP THE CARD FROM FALLING OUT, AS YOU TURN THE ENTIRE UNIT UPSIDE DOWN, PLACING IT ON TO A FLAT SURFACE, ON THE JIGS REST.

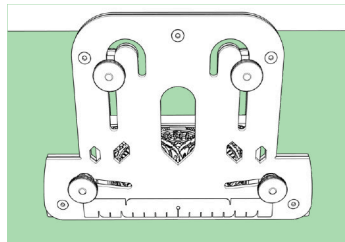

THE LEFT-HAND NOW SHIFTS TO THE JIGS SIDE, HOLDING IT UPRIGHT, THUMB IN FRONT (HALF ON THE JIG AND HALF ON THE FLAT SURFACE) WITH YOUR LEFT HAND FINGERS ON THE LIP CREATED BY THE UPTURNED JIGS REST. YOUR FINGERS AND THUMB ALL PRESS THE JIG DOWNWARDS, FIRMLY. THE OBJECTIVE HERE IS TO IMMOBILISE THE JIG, KEEPING IT STEADY AND UPRIGHT. THIS IS "LEFT HAND SETUP POSITION"

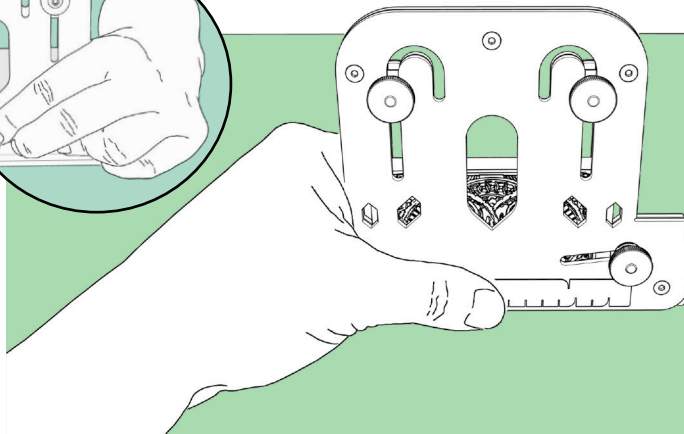

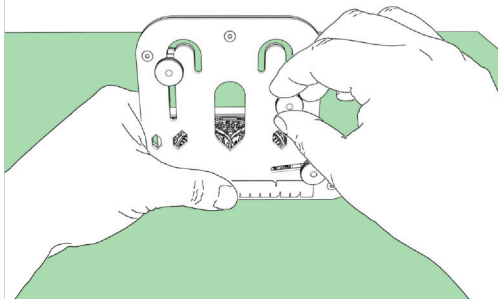

THE RIGHT-HAND NOW MOVES THE RIGHT DEPTH STOP DOWN UNTIL IT BUTTS AGAINST THE INTERNAL PLAYING CARD, AND TIGHTENS THE STOP. MAKE SURE THE STOP HAS FULLY BEDDED ITSELF - FLAT STOP EDGE AGAINST FLAT CARD EDGE. REPEAT WITH THE LEFT DEPTH STOP.

(THE CURRENT POSITION OF THESE TWO DEPTH STOPS WILL BE TEMPORARY, BUT IN THIS POSITION THEY PROVIDE HELP IN SETTING THE SIDE STOPS)

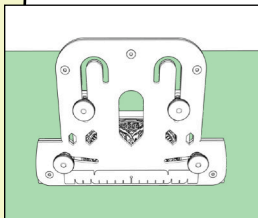

THE LEFT-HAND, IN A REVERSAL OF ITS PREVIOUS ACTIONS, NOW LIFTS THE JIG, AND IT IS HELD IN "HOLDING GRIP" POSITION (THE LEFT THUMB AND SECOND FINGER GRIPPING THE PLAYING CARD BETWEEN THE GRIP SPACE AS IT'S LIFTED).

THE CARDS LATERAL MOVEMENT WILL BE CONTAINED BY MOVING THE SIDE STOPS TOWARDS THE CARD AND TIGHTENING THEM, BUT FIRST YOU WILL NEED TO CENTRE THE CARD WITHIN THE JIG.

LINE UP THE SHORT EDGE OF PLAYING CARD WITH THE POKER LENGTH SET UP POINT. YOU CAN MOVE THE CARD Laterally IN SMALL MOVEMENTS USING YOUR LEFT THUMB AND SECOND FINGER THROUGH THE JIGS GRIP SPACE, SLIDING THE CARD PARALLEL WITH, AND AGAINST, THE TWO DEPTH STOPS, UNTIL ALIGNED.

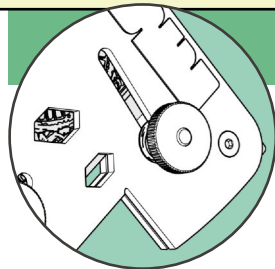
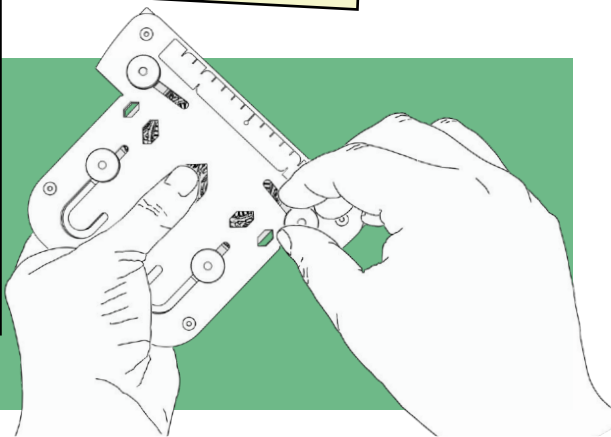

ONCE ALIGNED, THE LEFT THUMB AND SECOND FINGER FIRMLY PULL THE CARD TOWARDS THE TWO DEPTH STOPS, HOLDING THE CARD IN PLACE, AS YOU MOVE AND BUTT THE SIDE STOP CLOSEST TO YOU, AGAINST THE CARDS EDGE, AND TIGHTEN.

THE OTHER SIDE STOP IS BUTTED UP TO THE CARDS OTHER SHORT EDGE, HOWEVER, BEFORE IT IS TIGHTENED, THE LEFT THUMB AND SECOND FINGER, **MOVE THE CARD** A SMALL AMOUNT BACK AGAINST THE SIDE STOP (IMM AT MOST) THUS MOVING THE SIDE STOP ITSELF, IT IS THEN TIGHTENED. THIS ALLOWS THE CARD TO HAVE A SMALL AMOUNT OF LATERAL MOVEMENT BETWEEN BOTH SIDE STOPS, AND WILL HELP IN REMOVING AND REPLACING CARDS.

NOW THAT BOTH SIDE STOPS HAVE BEEN SET, THE DEPTH STOPS CAN NOW BE ADJUSTED FROM THEIR TEMPORARY POSITIONS...

AGAIN, THE LEFT-HAND TURNS THE ENTIRE UNIT UPSIDE DOWN, PLACING IT ON TO THE FLAT SURFACE, ON THE JIG'S REST.

LOOSEN BOTH DEPTH STOPS AND INITIALLY MOVE THEM UPWARDS, CLEAR OF

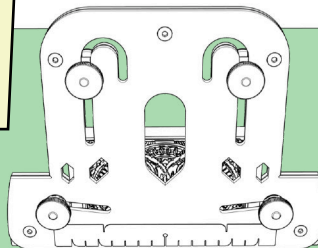
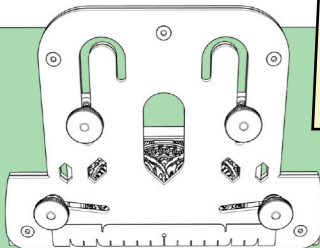

AT THIS POINT THE JIG AND IT'S INTERNAL CARD BOTH REST ON THE FLAT SURFACE.

SHIM MATERIAL IS USED TO DETERMINE THE DEPTH OF CUT, IN THIS EXAMPLE, PLAYING CARDS ARE USED AS A SHIM, BUT ANYTHING THIN CAN BE USED. THE DEPTH OF CUT IS DETERMINED BY MEASURING DIRECTLY OFF SHIM MATERIAL SET UNDER THE JIG.

PLACE A SHIM/ PLAYING CARD UNDER THE JIG'S RIGHT SIDE, ALIGNING ONE OF THE SHIM/CARD'S EDGES TO THE OUTSIDE EDGE OF THE JIG'S GAUGE.

(THIS POSITION WILL REMAIN CONSISTENT NO MATTER WHAT TYPE OF GAFF YOU ARE CUTTING.)

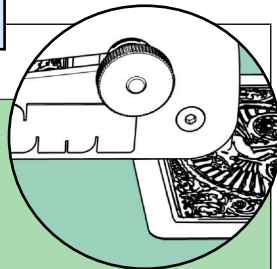
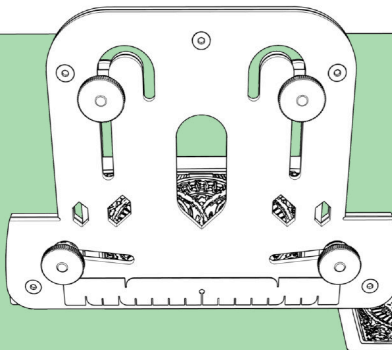

THIS RISES THE RIGHT SIDE OF THE JIG, ONE SINGLE SHIM/CARDS THICKNESS, OFF THE FLAT SURFACE. HOWEVER BECAUSE OF WHERE YOU PLACED THE SHIM/CARD, THE JIG'S INTERNAL CARD IS STILL RESTING ON THE FLAT SURFACE.

MOVE THE RIGHT **DEPTH STOP** DOWN TO BUTT AGAINST THE INTERNAL CARD. DON'T TIGHTEN IT YET.

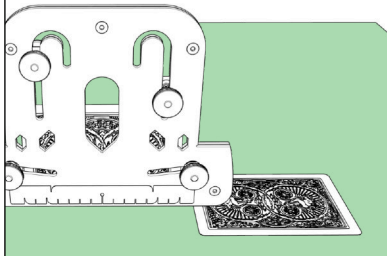

PLACE A SECOND SHIM/PLAYING CARD UNDER THE JIG'S LEFT SIDE...

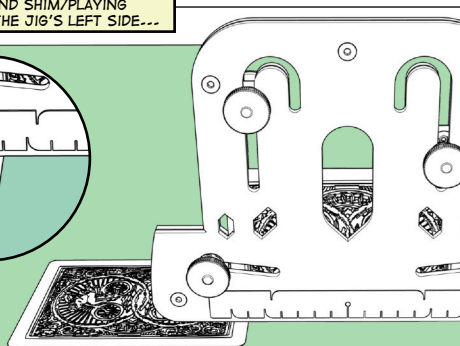
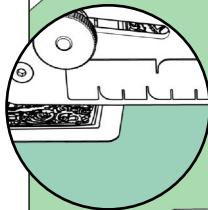

...ALIGNING ONE OF THE SHIM/CARD'S EDGES TO THE OUTSIDE OF THE SECOND NOTCH ON THE JIG'S GAUGE.

THIS RISES THE LEFT SIDE OF THE JIG, ONE SINGLE SHIM/CARDS THICKNESS, OFF THE FLAT SURFACE, HOWEVER THIS TIME, BECAUSE OF WHERE YOU PLACED THIS SHIM/CARD, THE CORNER OF THE JIG'S INTERNAL CARD IS NO LONGER RESTING ON THE FLAT SURFACE BUT IS **RESTING ON THE SHIM/CARD**.

MOVE THE LEFT **DEPTH STOP** DOWN TO BUTT AGAINST THE INTERNAL CARD. DON'T TIGHTEN IT YET.

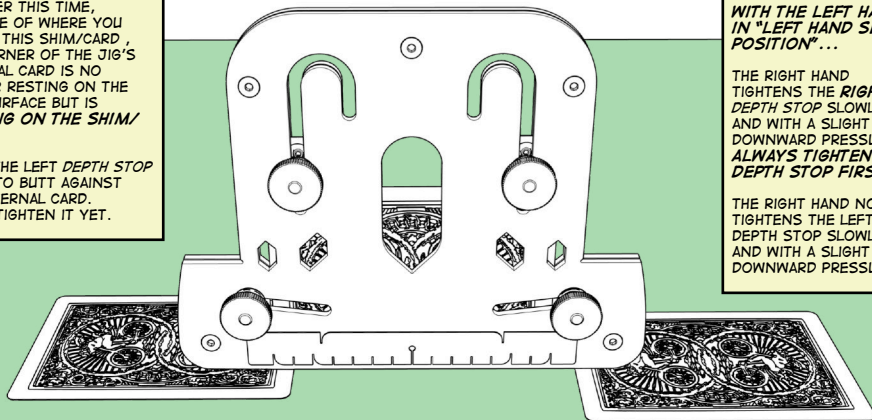

**WITH THE LEFT HAND IN "LEFT HAND SETUP POSITION" ...**

THE RIGHT HAND TIGHTENS THE **RIGHT DEPTH STOP** SLOWLY AND WITH A SLIGHT DOWNWARD PRESSURE- **ALWAYS TIGHTEN THIS DEPTH STOP FIRST.**

THE RIGHT HAND NOW TIGHTENS THE **LEFT DEPTH STOP** SLOWLY AND WITH A SLIGHT DOWNWARD PRESSURE.



THE JIG IS SET...

...A TAPER CAN NOW BE CUT ALONG THE EDGE OF THE CARD.  
-THE THICKNESS OF A SINGLE SHIM/CARD AT ONE END TAPERING TO NOTHING AT THE OTHER END,

THE JIG IS IN LEFT HAND "**HOLDING GRIP**", THUMB AND SECOND FINGER GRIP AND PULL THE INTERNAL CARD FIRMLY TOWARDS THE **DEPTH STOPS**, THIS ACTION ALONG WITH ALL FOUR STOPS, IMMOBILISE THE CARD.

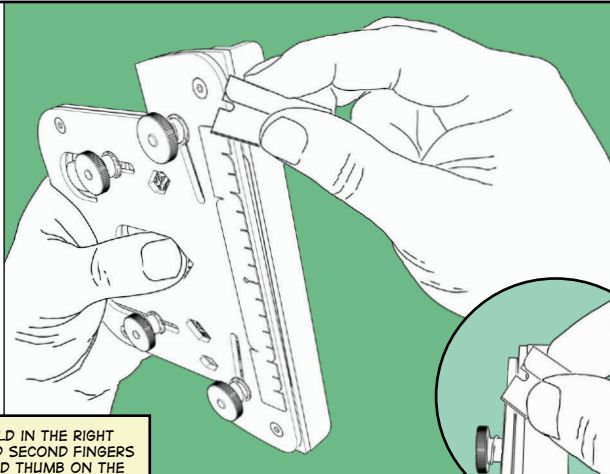

THE BLADE IS HELD IN THE RIGHT HAND, FIRST AND SECOND FINGERS ON ONE SIDE AND THUMB ON THE OTHER. PLACE THE BLADE'S EDGE ONTO THE JIG'S REST JUST ABOVE THE PROTRUDING CARD, AT AN ANGLE APPROX. 30°.

MOVING THE BLADE FROM ONE END OF THE REST TO THE OTHER, THE CARD IS CUT.

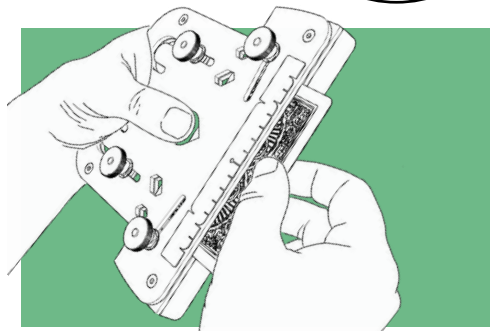

ONCE CUT, THE LEFT THUMB KICKS THE EDGE OF THE CARD OUTWARDS, FROM THE **GRIP SPACE**, ENABLING THE NOW GAFFED CARD TO BE EASILY REMOVED FROM THE JIG.

...ANOTHER CARD IS PLACED INTO THE JIG AND THE CUTTING PROCEDURE IS REPEATED.

## ADDITIONAL SETTINGS...

DIFFERENT LENGTHS OF TAPER, AS WELL AS STRAIGHT CUTS, CAN BE ACHIEVED BY CHANGING THE POSITION OF THE **LEFT** SIDE SHIM/CARD ALONG THE JIG'S **GAUGE**. (THE RIGHT SHIM/CARD IS **ALWAYS** PLACED UNDER THE JIG'S RIGHT SIDE, ALIGNING ONE OF THE SHIM/CARD'S EDGES TO THE OUTSIDE EDGE OF THE JIG'S **GAUGE**).

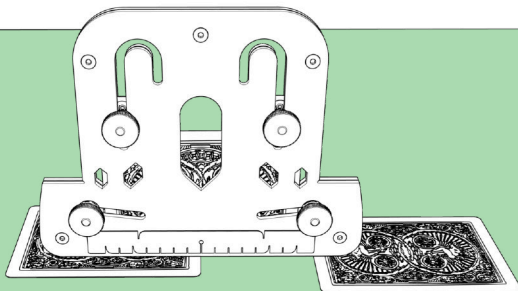

FOR EXAMPLE, IF THE LEFT SHIM/CARD IS PLACED UNDER THE JIG'S LEFT SIDE, ALIGNING ONE OF THE SHIM/CARD'S EDGES WITH THE **MIDPOINT MARKER** NOTCH ON THE JIG'S **GAUGE**, THIS RISES THE LEFT SIDE OF THE JIG OFF THE FLAT SURFACE, BUT THIS TIME, BECAUSE OF WHERE YOU PLACED THE SHIM/CARD, THE MIDPOINT OF THE JIG'S INTERNAL CARD'S EDGE IS NO LONGER RESTING ON THE FLAT SURFACE BUT IS RESTING ON THE EDGE OF THE SHIM/CARD, CREATING A TAPER FROM ONE END, TO NOTHING HALF WAY ALONG THE CARD'S LENGTH...

...SO PLACING THE SECOND SHIM/CARD AT DIFFERENT NOTCHES ALONG THE JIG'S **GAUGE** WILL CREATE DIFFERENT LENGTHS OF TAPER.

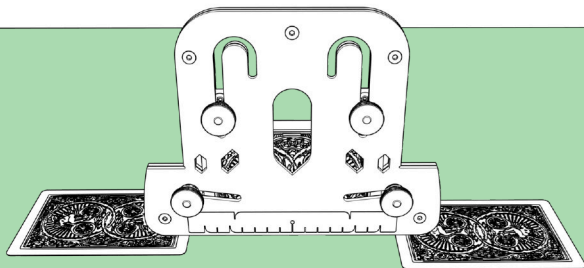

TO CREATE A STRAIGHT CUT, THE SECOND SHIM/CARD IS PLACED UNDER THE JIG'S LEFT SIDE, ALIGNING ONE OF THE SHIM/CARD'S EDGES TO THE OUTSIDE EDGE OF THE JIG'S **GAUGE**. (THIS MIRROR'S THE RIGHT SHIM/CARD POSITION) BOTH SIDES OF THE JIG HAVE BEEN RAISED BUT THE FULL EDGE OF THE JIG'S INTERNAL CARD REMAINS ON THE FLAT SURFACE. CREATING A CONSISTENT DEPTH FROM ONE SIDE TO THE OTHER.

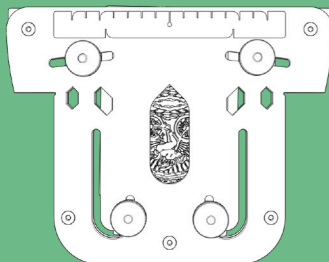

THE SAME GAFFS CAN BE MADE WITH THE CARDS IN PORTRAIT POSITION.

### PROCEDURE FOR BELLY STRIPPERS...

FOR THE BELLIED CARD ITSELF, FOUR CUTS AND TWO JIG SETUPS ARE REQUIRED. TWO CUTS ALONG ONE EDGE PRODUCE ONE OF THE BELLIED EDGES- RESET THE JIG, AND TWO CUTS ON THE OTHER EDGE FINISH THE BELLY...

SETUP THE JIG TO CUT A TAPER, ONE SHIM/CARD IN DEPTH, FROM ONE END OF THE CARD TO HALF WAY ALONG IT'S LONG EDGE... THIS IS CUT ONE.

REMOVE THE CARD AND TURN IT END OVER END (THE PREVIOUS CUT EDGE IS STILL OUTWARDS), REPLACE IT INTO THE JIG AND CUT THE OTHER HALF OF THE LONG EDGE. THIS IS CUT TWO, AND GIVES YOU A CARD WITH ONE LONG EDGE BELLIED OUT AT IT'S CENTRE...IT'S OPPOSITE LONG EDGE IS STILL UNCLUT.

REPEAT THESE ACTIONS WITH THE OTHER CARDS FROM THE DECK YOU WISH TO BELLIE. THIS WILL GIVE YOU A NUMBER OF CARDS ALL OF WHICH WILL HAVE ONE LONG EDGE BELLIED.

**THE JIG'S DEPTH STOPS NOW NEED TO BE RESET TO CUT THE CARDS OPPOSITE LONG EDGES.**

THE SAME SETUP PROCEDURE YOU USED INITIALLY IS USED AGAIN - THE ONLY DIFFERENCE THIS TIME IS THAT **THE PREVIOUS CUT LONG EDGE IS INSERTED INWARDS, INTO THE JIG**, AND IT IS THIS EDGE THAT THE DEPTH STOPS WILL BE RESET AND BUTTED AGAINST.

AS BEFORE, SETUP THE JIG TO CUT A TAPER, ONE SHIM/CARD IN DEPTH, FROM ONE END OF THE CARD TO HALF WAY ALONG IT'S LONG EDGE...THIS IS CUT THREE.

REMOVE THE CARD AND TURN IT END OVER END, REPLACE IT INTO THE JIG AND CUT THE OTHER HALF OF THE LONG EDGE, THIS IS THE FOURTH AND FINAL CUT. REPEAT THESE ACTIONS FOR THE OTHER BELLIED CARDS.

THE REMAINING CARDS IN THE DECK (THE NON-BELLIED) ARE ALL NOW GIVEN A STRAIGHT CUT ALONG ONE LONG EDGE, ONE CARD/SHIM THICKNESS.

WITH THE DECK FULLY ASSEMBLED, THE BELLIED CARDS CAN NOW BE STRIPPED FROM THE DECK.

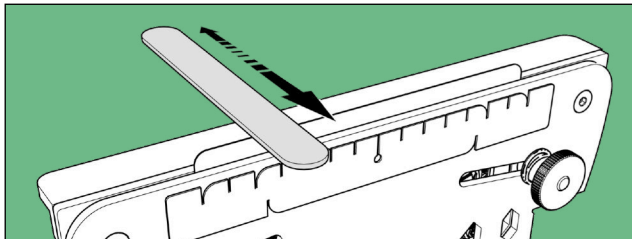

### N-STRIPPER

THE STRIPPER JIG CAN ALSO HELP IN THE PRODUCTION OF VARIOUS N-STRIPPER/ CONCAVE TYPE GAFFS. A CARD IS CENTRED WITHIN THE JIG WITH A DEPTH THICKNESS OF 10 SHIM/CARDS EACH SIDE. THIS POSITIONS A CARD WITH AN EXPOSED EDGE ALONG THE GAP CUT LINE. USING A DIAMOND FILE OR WHETSTONE (NEVER USE SANDPAPER) THE CARDS EDGE IS FILED BY MOVING THE FILE PERPENDICULARLY AGAINST THE CARDS EDGE, AND USING THE JIG'S GAUGE TO DETERMINE THE POSITIONING. (CIRCLING BETWEEN TWO SELECTED MARKS ON THE GAUGE), A LIGHT CONCAVE "NOTCH" CAN BE PRODUCED IN A FEW STROKES. THE SLIGHT MOVEMENT AND FLEXIBILITY OF THE CARD MAKE FOR A BURR FREE FINISH.

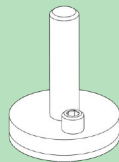
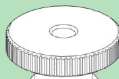

### MAINTENANCE:

SIMPLY KEEP IT CLEAN, OCCASIONALLY LUBRICATE WITH TEFLON POWDER. DIRT BETWEEN THE PLATES COULD CAUSE THE STOPS TO BIND-IF THIS HAPPENS- JIGGLE THE STOPS, MOVE THEM ALONG THEIR SLOTS AND BLOW DIRT OUT. **AS A LAST RESORT** THE STOPS CAN BE REMOVED AND THE SHIM WASHERS SLID OUT FROM BETWEEN THE PLATES (NEVER DISMANTLE THE PLATES!) BUT **NOTE: DON'T MIX THE PARTS! HERE'S WHY...**

THERE ARE REALLY THREE SECTIONS THAT MAKE UP THE STOPS. THE FIRST SECTION, CONSISTS OF A THUMB SCREW, SPRING AND WASHER, AND ARE LOCATED ON THE FACE PLATE. THE SECOND SECTION, CONSISTS OF TWO SHIMS, ONE SQUARE AND ONE ROUND, AND THESE ARE SANDWICHED BETWEEN THE FACE PLATE AND THE BACK PLATE. THE THIRD SECTION CONSISTS OF A BOLT AND LOCKING PIN AND ARE LOCATED ON THE BACK PLATE.

**FULLY** TIGHTENING THE THUMBSCREW AND BOLT, CAUSES THE FACE PLATE AND BACK PLATE TO FLEX TOGETHER SLIGHTLY, TIGHTENING ONTO THE SHIMS SANDWICHED BETWEEN THEM. IN THE CASE OF THE DEPTH STOPS, THE SQUARE SHIM IS THICKER THAN THE ROUND SHIM THEREFORE THE SQUARE SHIM IS ENGAGED AND LOCKED INTO POSITION AS THE THUMB SCREW IS TIGHTENED.

THE SIDE STOPS ARE DIFFERENT, IN THEIR CASE THE ROUND SHIM IS THICKER THAN THE SQUARE SHIM, SO THE ROUND SHIM IS ENGAGED AND LOCKED INTO POSITION AS THE THUMB SCREW IS TIGHTENED. THIS ALLOWS THE THINNER SQUARE SHIM TO ROTATE - ENABLING THE EASY REMOVAL AND REPLACEMENT OF PLAYING CARDS.

[WWW.THEPERFECTSHUFFLE.COM](http://WWW.THEPERFECTSHUFFLE.COM)

© 2012 O'HARE

## CONCAVE CUTS...

CUTTING A CONCAVE TYPE CUT VARIES FROM THE NORMAL PROCEDURE - IT'S POSITIONING OF THE SHIMS/CARDS DIFFERS...

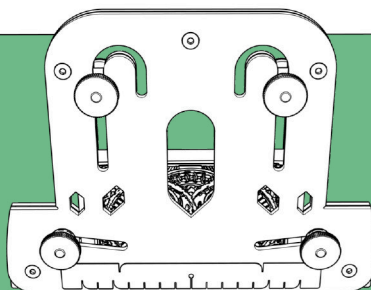

WITH THE INTERNAL CARD **CENTRED** AND **SIDE STOPS** SET (SEE THE MAIN **USER GUIDE**) THE ENTIRE UNIT IS SET UPSIDE DOWN ONTO A FLAT SURFACE, ON THE JIG'S REST.

SHIM MATERIAL IS USED TO DETERMINE THE DEPTH OF CUT. HERE, PLAYING CARDS ARE USED AS SHIMS, BUT ANYTHING THIN CAN BE USED.

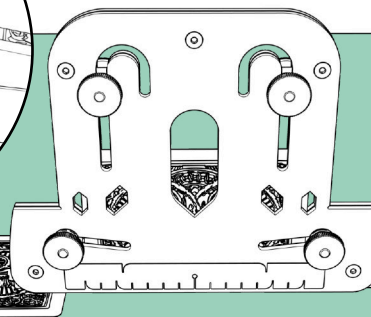
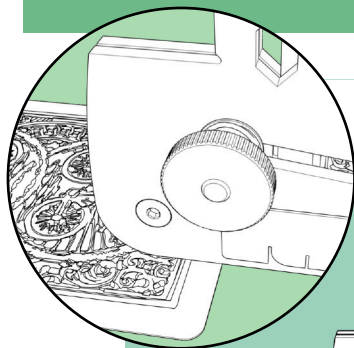

PLACE A SHIM/ CARD UNDER THE **LEFT SIDE**, ALIGNING ONE OF THE SHIM/CARD'S EDGES TO THE OUTSIDE EDGE OF THE JIG'S **GALUGE**.

NOTE THAT THE JIG'S INTERNAL CARD'S EDGE STILL RESTS ON THE FLAT SURFACE.

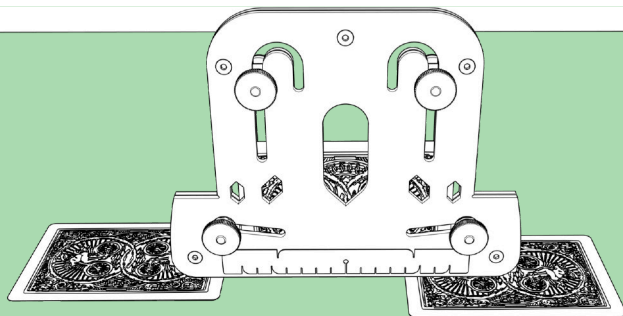

PLACE A SECOND  
SHIM/CARD  
UNDER THE  
*RIGHT SIDE* ...

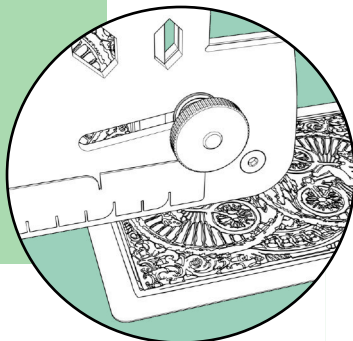

...THE POSITION OF THIS SHIM/CARD CAN VARY DEPENDING ON THE CUT YOU REQUIRE. IN THIS EXAMPLE, THE CARD IS PLACED THREE NOTCHES FROM THE POKER/BRIDGE LENGTH MARKER, WHICH WILL ULTIMATELY RESULT IN THE CARD EDGE BEING DIVIDED INTO THIRDS—  
UNCUT / CONCAVE CUT / UNCLUT.

**WITH THE LEFT  
HAND IN "LEFT  
HAND SETUP  
POSITION" ...**

THE RIGHT HAND  
MOVES THE **LEFT**  
DEPTH STOP DOWN  
TO BUTT AGAINST  
THE INTERNAL CARD  
AND TIGHTENS IT.

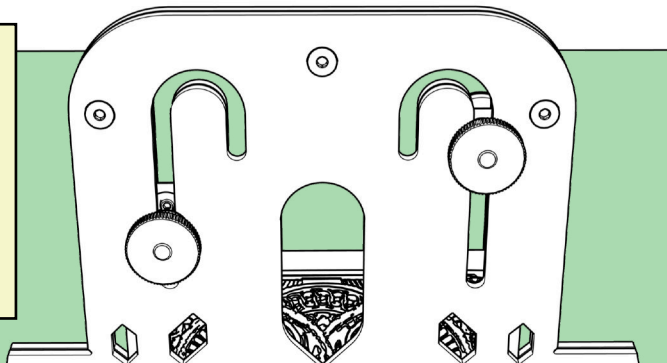

THE RIGHT HAND  
MOVES THE  
**RIGHT DEPTH**  
STOP DOWN TO  
BUTT AGAINST  
THE INTERNAL  
CARD AND  
TIGHTENS IT .

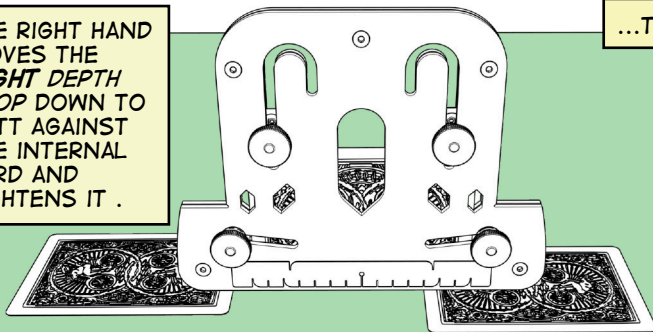

...THE RESULT...

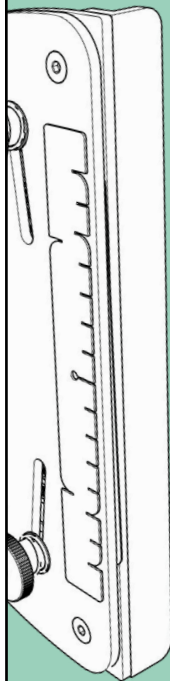

THE JIG IS IN LEFT HAND "HOLDING GRIP". THUMB  
AND SECOND FINGER GRIP AND PULL THE INTERNAL  
CARD FIRMLY TOWARDS THE DEPTH STOPS.

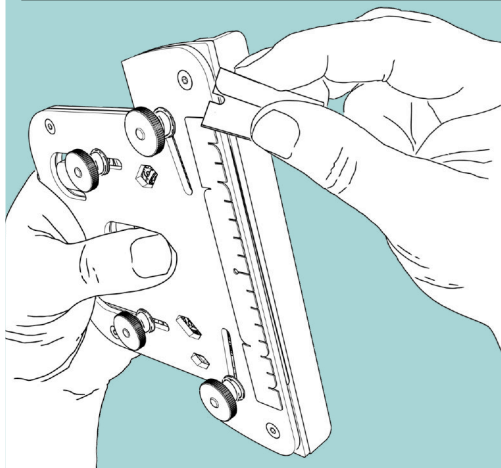

THE BLADE IS  
HELD IN THE  
RIGHT HAND,  
FIRST AND  
SECOND FINGERS  
ON ONE SIDE AND  
THUMB ON THE  
OTHER. PLACE THE  
BLADE'S EDGE  
ONTO THE JIG'S  
REST (ABOVE THE  
GAUGE'S POKER/  
BRIDGE LENGTH  
MARKER) AT AN  
ANGLE OF  
APPROX. 30°

NOTICE THE THIN  
WEDGE SHAPE OF  
THE CARD TAPERS  
AWAY FROM  
YOU- (OPPOSITE  
DIRECTION FROM  
NORMAL)

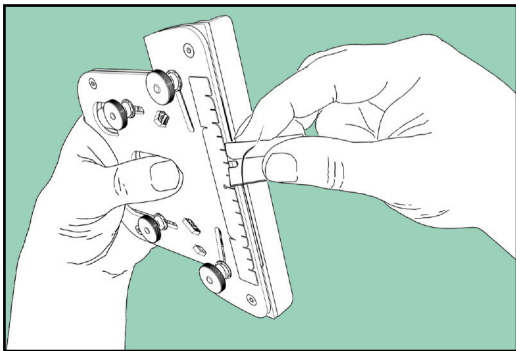

MOVE THE  
BLADE  
SLOWLY  
DOWN THE  
REST,  
CUTTING THE  
CARD. **STOP**  
AT THE MID-  
POINT  
MARKER ON  
THE JIG'S  
GAUGE.

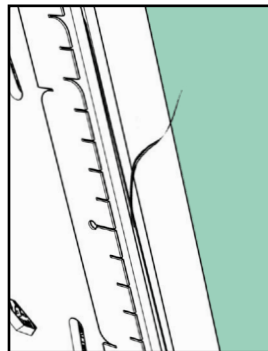

ONCE CUT ,THE LEFT HAND  
THUMB KICKS THE EDGE OF THE  
CARD OUTWARDS, FROM THE  
GRIP SPACE, ENABLING THE  
NOW PARTIALLY CUT CARD TO  
BE REMOVED FROM THE JIG...

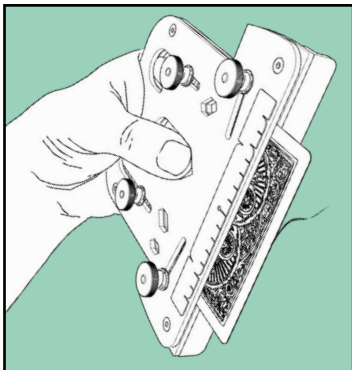

...TURN THE  
CARD END  
OVER END,  
(THE PREVIOUS  
CUT EDGE IS  
STILL  
OUTWARDS),  
REPLACE IT  
INTO THE JIG...

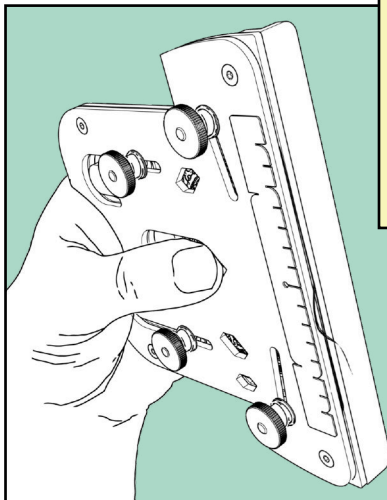



...CUT THE OTHER HALF OF THE CONCAVE, BY MOVING THE BLADE SLOWLY DOWN THE REST. **STOP AT THE MID-POINT MARKER ON THE JIG'S GAUGE**— MEETING THE OTHER CUT— COMPLETING THE CUT.

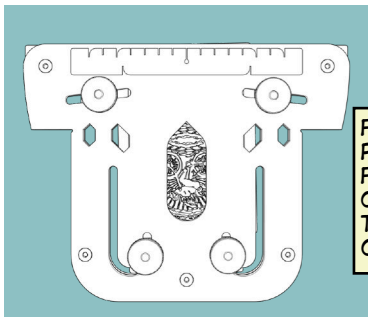
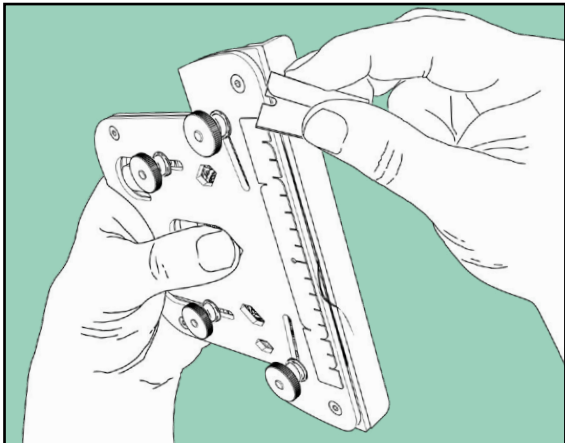

**FOLLOW SIMILAR PROCEDURES FOR CUTTING CONCAVES ON THE END EDGES OF CARDS.**

#### **PROCEDURE FOR CONCAVE TYPE CUTS...**

FOR THE CONCAVE CARD ITSELF, FOUR CUTS AND TWO JIG SETUPS ARE REQUIRED. TWO CUTS ALONG ONE EDGE PRODUCE ONE OF THE CONCAVED EDGES— RESET THE JIG, AND TWO CUTS ON THE OTHER EDGE FINISH THE CONCAVE CARD...

AS DESCRIBED, SETUP THE JIG TO CUT A TAPER, ONE SHIM/CARD IN DEPTH, FROM ONE END OF THE CARD TO YOUR CHOSEN GAUGE MARKER ALONG IT'S LONG EDGE...CUT FROM THE THINNEST TAPERING SIDE OF THE CARD TO THE MID-POINT GAUGE MARKER...THIS IS CUT ONE. REMOVE THE CARD AND TURN IT END OVER END (THE PREVIOUS CUT EDGE IS STILL OUTWARDS), REPLACE IT INTO THE JIG AND CUT THE OTHER HALF OF THE LONG EDGE. THIS IS CUT TWO, AND GIVES YOU A CARD WITH ONE LONG EDGE CONCAVED AT IT'S CENTRE...IT'S OPPOSITE LONG EDGE IS STILL UNCUT.

REPEAT THESE ACTIONS WITH THE OTHER CARDS FROM THE DECK YOU WISH TO CONCAVE. THIS WILL GIVE YOU A NUMBER OF CARDS ALL OF WHICH WILL HAVE ONE LONG EDGE CONCAVED.

**THE JIG'S DEPTH STOPS NOW NEED TO BE RESET TO CUT THE CARDS OPPOSITE LONG EDGES.**

THE SAME SETUP PROCEDURE YOU USED INITIALLY IS USED AGAIN — THE ONLY DIFFERENCE THIS TIME IS THAT **THE PREVIOUS CUT LONG EDGE IS INSERTED INWARDS, INTO THE JIG**, AND IT IS THIS EDGE THAT THE DEPTH STOPS WILL BE RESET AND BUTTED AGAINST.

AS BEFORE, SETUP THE JIG TO CUT A TAPER, ONE SHIM/CARD IN DEPTH, FROM ONE END OF THE CARD TO YOUR CHOSEN GAUGE MARKER, ALONG IT'S LONG EDGE....CUT FROM THE THINNEST TAPERING SIDE OF THE CARD TO THE MID-POINT GAUGE MARKER...THIS IS CUT THREE. REMOVE THE CARD AND TURN IT END OVER END, REPLACE IT INTO THE JIG AND CUT THE OTHER HALF OF THE LONG EDGE, THIS IS THE FOURTH AND FINAL CUT. REPEAT THESE ACTIONS FOR THE OTHER CONCAVE CARDS.

**THIS TYPE OF CUT REQUIRES COMPLETE FAMILIARITY WITH THE JIG! PRACTICE.**

### ***BELLY END STRIPPERS***

AN ADDITIONAL STEP IS REQUIRED WHEN CUTTING BRIDGE/POKER END BELLIES. DUE TO THE SHORT LENGTH OF TAPER REQUIRED , IT IS NECESSARY TO POSITION ONE OF THE *DEPTH STOPS* A LITTLE FURTHER OVER THE CORNER OF THE CARD. THIS IS ACHIEVED BY OFF-SETTING THE CARD FROM THE NORMAL CENTRAL POSITION. HERE'S HOW...

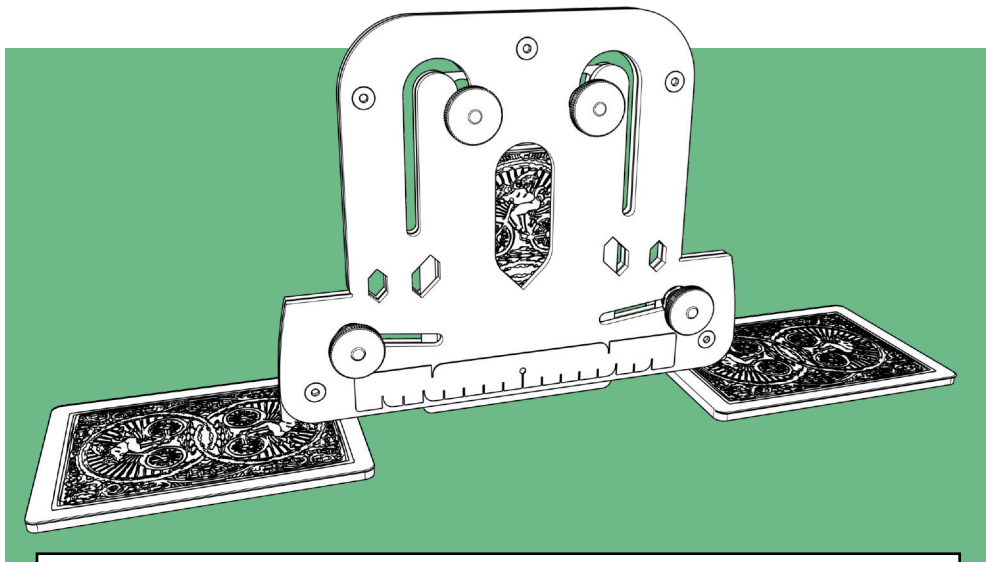

FIRST, IN ORDER TO SET THE *SIDE STOPS*, YOU WILL NEED TO TEMPORARILY POSITION THE *DEPTH STOPS*... WITH A CARD IN A PORTRAIT POSITION WITHIN THE JIG, PLACE THE JIG ONTO A FLAT SURFACE WITH A PILE OF 10 PLAYING CARDS EITHER SIDE. MOVE THE DEPTH STOPS AGAINST THE TOP EDGE OF THE INTERNAL CARD. MAKING SURE BOTH STOPS HAVE BEDDED THEMSELVES, TIGHTEN BOTH.

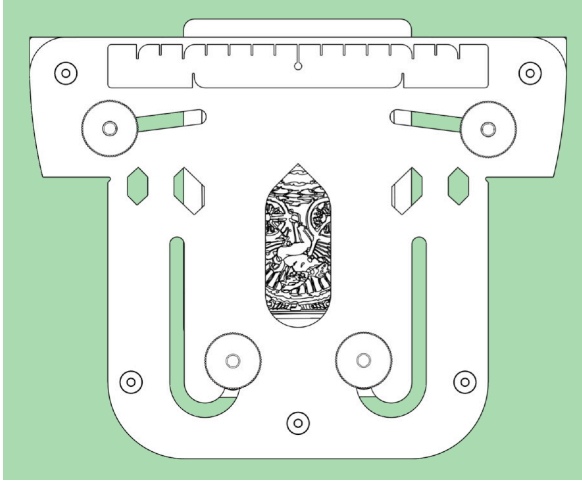

LIFT THE JIG TO SEE  
THAT THE INTERNAL  
CARD NOW PROTRUDES  
THE HEIGHT OF 10  
CARDS BEYOND THE  
CUTLINE AND IS STILL  
FREE TO MOVE FROM  
SIDE TO SIDE.

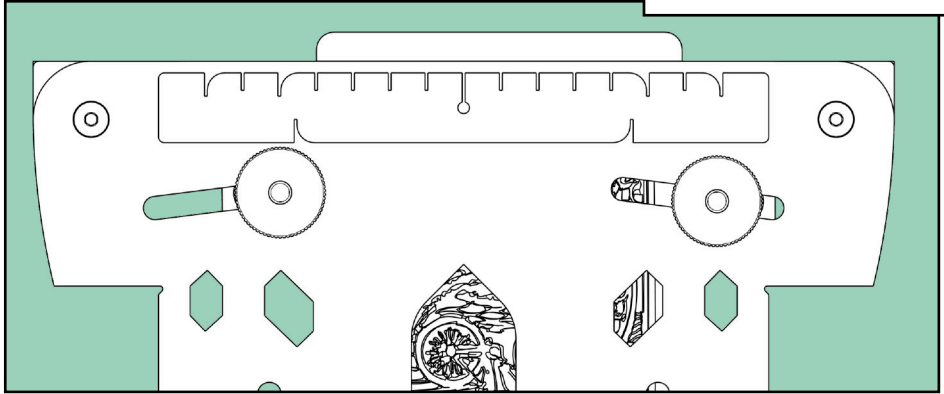

SLIDE THE CARD TO THE  
RIGHT, THE DISTANCE OF  
ONE NOTCH ON THE JIG'S  
GALIGE, AND MOVE THE  
*SIDE STOPS* AGAINST THE  
CARD AS EXPLAINED IN  
THE USER GUIDE.

NOW YOU CAN LOOSEN THE TWO DEPTH STOPS AND MOVE THEM TO THE BOTTOM OF THEIR RESPECTIVE U-SLOTS.

CONTINUE AS DESCRIBED IN THE MAIN USER GUIDE. JUST REMEMBER THAT THE CARD IS NOW OFF-SET CENTRE BY ONE NOTCH.

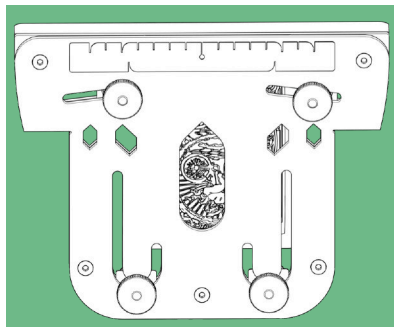

TIGHTEN THE RIGHT DEPTH STOP FIRST!

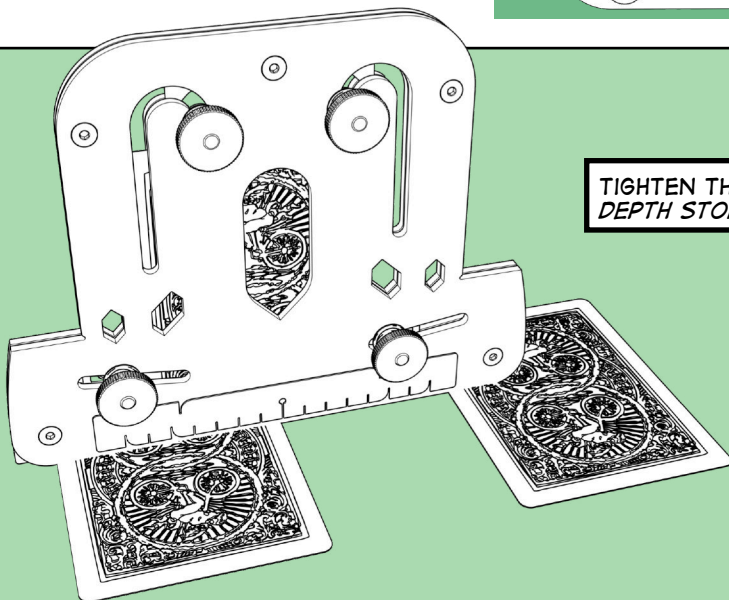

[WWW.THEPERFECTSHUFFLE.COM](http://WWW.THEPERFECTSHUFFLE.COM)

© 2012 O'HARE